

MANCHESTER TOWNSHIP SECTION 6 R 10 TWP 7 MORGAN COUNTY, OHIO

PIN	Owner	LegalDescr	Acres	VOL	PAGE	Survey_Ref
090-002-150-1	GUERNSEY MUSKINGUM ELECTRI	R10 T07 S06 SD 14	1.912	OR224	266	MAN-0084.pdf
090-002-150-3	OHIO DEPT OF NATURAL RESOU	R10 T7 S6 SD3	284.94	OR235	140	MAN-0114-G.p
090-002-150-0	OHIO FRANKLIN REALTY LLC	R10 T07 S06 SD 1	2.78	OR232	4664	NoSurvey.pdf
090-002-150-2	STATE OF OHIO DEPARTMENT O	R10 T7 S6 SD2	323.78	OR233	2579	MAN-0107-A.p

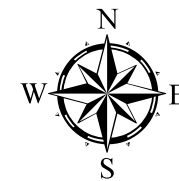

Boundaries			
	Hydro		Section
	Roads		Lot
	County		Township
	Parcel		ROW

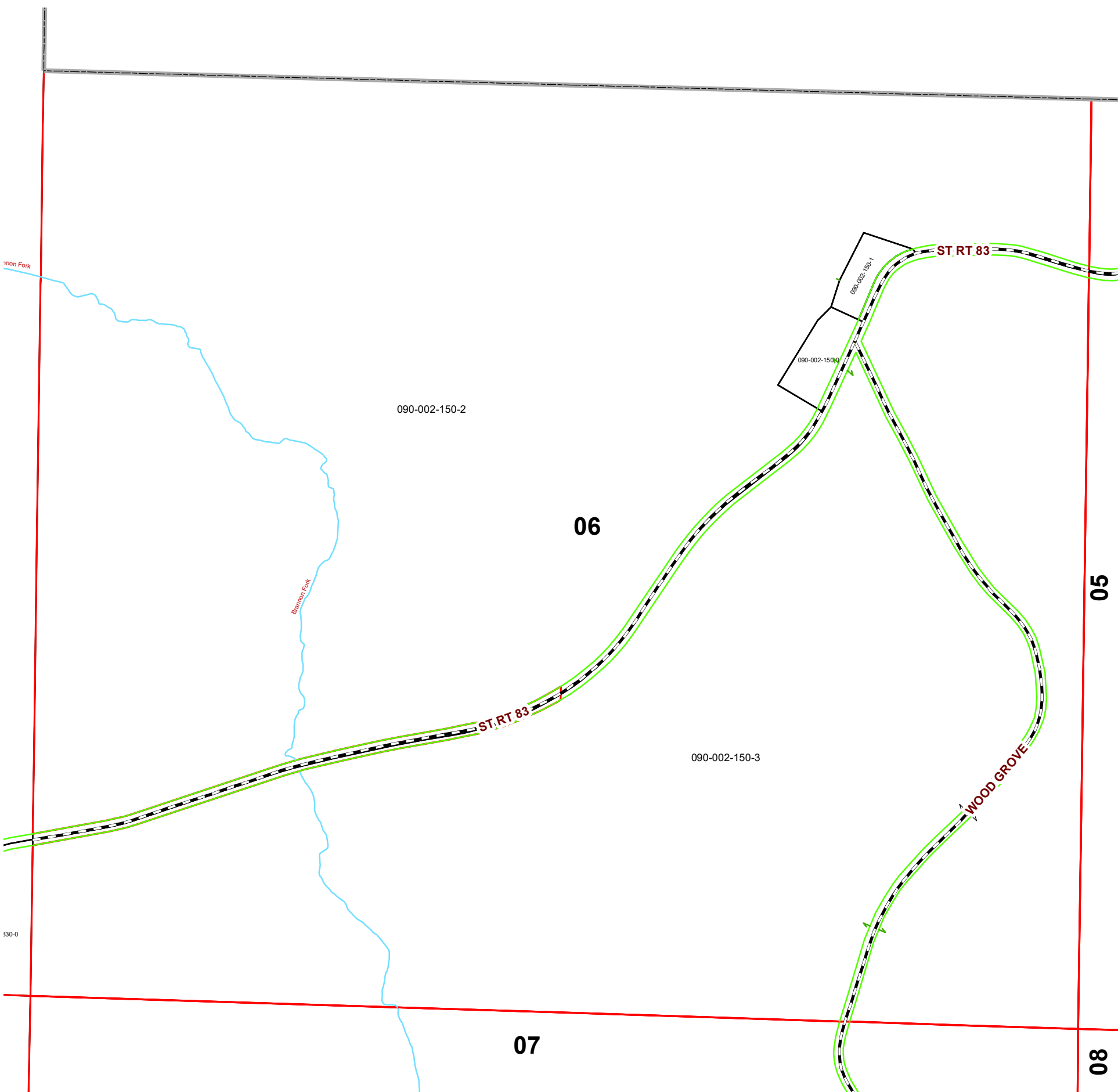
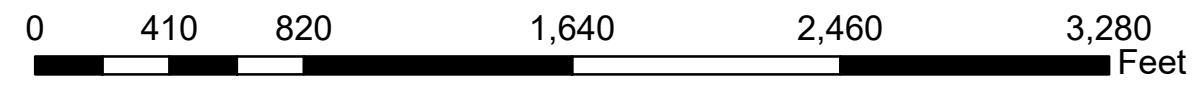

Disclaimer: The information that these maps contains is for reference purposes only. Please bring any erros to the attention of the Engineer's Office staff. Thank you

Source: Morgan County Engineer's Office
 Author: Marcia Wolfe
 Date: 12/31/20